

UNDERSTANDING YOUR RURAL ADDRESS



COUNTY OF VERMILION RIVER PLANNING & COMMUNITY SERVICES DEPARTMENT

<https://www.vermilion-river.com/departments/community-services/development-permits>

Is My Rural Address The Same as My Mailing Address?

- No. The Rural Address is the PHYSICAL address of the property and does not have a postal code associated with it

What Is The Difference Between a Legal Land Location and a Rural Address?

- Legal Land Location identifies the property location on a specific ¼ section
- Rural Address shows the ACCESS to the property off of a road allowance
 - This is very important for emergency services to actually get to your residence or business

Who Will Have Access to my Rural Address?

- CVR assigns and maintains Rural Addresses and shares them with Emergency Responders
- Landowners can share their Rural Address to couriers, utility companies, visitors, etc. at their own discretion

What Should I Do With My Rural Address?

- Memorize it, post it in your home, educate your family
 - You will give an Emergency Dispatcher your Rural Address in the case of an emergency

What Is My Rural Address?

- Example of a Rural Address in a residential subdivision:
 - 74 Blackfoot Road, 500076 Range Road 23, Morning Gold Estates, County of Vermilion River
- Example of a Rural Address in the country:
 - 15068 Township Road 502, County of Vermilion River

Who Installs the Rural Address Signs?

- Only CVR and/or our contractor are authorized to install signs
- By default, all signs will be installed on the South-east side of your driveway, unless pre-existing conditions prohibit that placement

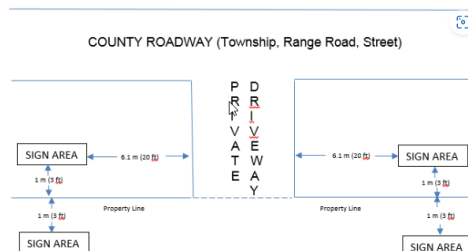

QUICK FACTS:

- A) Rural Address signs are mandatory for all developed rural properties with an inhabited residence or business
- B) All new development will be required to pay a fee for the Rural Address Sign to be installed

24036
TWP RD 500

50020
RGE RD 24

REVISION DATE: May 2023