

Break and enters and vehicle thefts are two of the most common police-reported crimes in Canada.

THREAT + VULNERABILITY = RISK

Many of these simple steps can help deter and reduce property crime.

WHAT DOES THE GREEN SIGN OUT FRONT OF YOUR PROPERTY SAY?

Securing your property can also improve emergency response efficiency.



BE READY

RURAL PROPERTY SECURITY



BE READY

RURAL PROPERTY SECURITY

Kitscoty RCMP Detachment
Kitscoty, Alberta
780-846-2870

DETERRENCE

Deterrence is your first line of defence to making your property secure. It can range from lighting/motion sensors, no trespassing signs, barking dogs and installing fences and secure gates that are closed unless entering or leaving the property. Even trail cameras have aided in investigations.

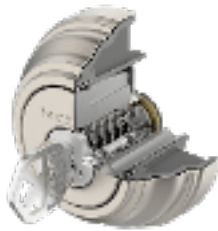

KNOWLEDGE OF PROPERTY

The most important factor in safety and property security is knowing your property. Starting with you green sign, this sign is your specific address and will garner the quickest response from emergency services. A land location could have multiple properties on it which can delay arrival times by minutes.

SECURITY

Properly securing the buildings on your property is another great deterrent. Refrain from leaving vehicle keys easily accessible and around the vehicle. Ensure all outbuildings are closed and locked when unattended. The longer it takes to break in the greater chance of detection.

LAYOUT

Knowing the weak points of your property can help determine possible point of entry. If an emergency occurs it is important to know the layout of your property and the main contents within the buildings. This will aid the emergency personnel in effectively combating your emergency e.g, fire, crime, etc

ALTERNATIVE MEASURES



A security system, when the finances correspond, is another great emergency system. The system garners a quick response from emergency services. They can alert you of the following:

- Intruders
- Fires
- Floods
- Distress calls.

Ultimately, property crime is a constant concern and taking these steps will not guarantee the safety of your property but it can go a long way in reducing the success rates. These steps not only help to deter crime but also increase emergency service response. For more tips or questions contact the RCMP and/or Rural Crime Watch.

CONTACT US ▲

Phone:780-846-2870

Fax: 780-846-2943

Do you know your civic address?
It is important that you do. ▲